



## BAC Residence Hall Option at New England Conservatory.

Are you an incoming or returning BAC student looking who would enjoy a traditional college residence hall experience? The BAC is partnering with the New England Conservatory to provide this. The New England Conservatory's Residence is located at 255 St. Botolph Street – a quick fifteen-minute walk from the BAC, or a short bus ride on the #1 bus. The location is in a safe, lively area in proximity to many Boston attractions like the Prudential Center, Fenway Park, and many amazing restaurants and shops.

Double rooms are available – shared with other BAC students, with shared bathrooms and lounge space. Accommodations are roomy enough for doing your schoolwork and close enough to campus to take advantage of late-night studio space there.



### ROOM AND BOARD

The price per person for the Fall 2024 Semester includes the meal plan. The dining hall is located in the same building and is shared with NEC students. Grab and go options are also available.

Double Room: \$9,650

(\*this price is for F24/S25 school year and is subject to change)

\* Additional BAC financial aid may be available



### AMENITIES

- Resident Assistants are BAC students who can offer helpful practical advice.
- Access to NEC's campus spaces such as lounges/social spaces on each floor
- Trash and recycling rooms on each floor
- Use of laundry machines (\$3 per load)
- Communal kitchen is located on the building's 4th Floor.

## SECURITY

New England Conservatory's Campus Safety department works to protect students' welfare on campus. Three security officers, including a supervisor are always on duty. In addition, NEC's front door is manned 24- hours a day while at least one officer walks the campus.

## INTERESTED?

For more information, and to fill out a roommate questionnaire, please contact BAC Office of Student Life, at **617.585.0269** or **studentlife@the-bac.edu**

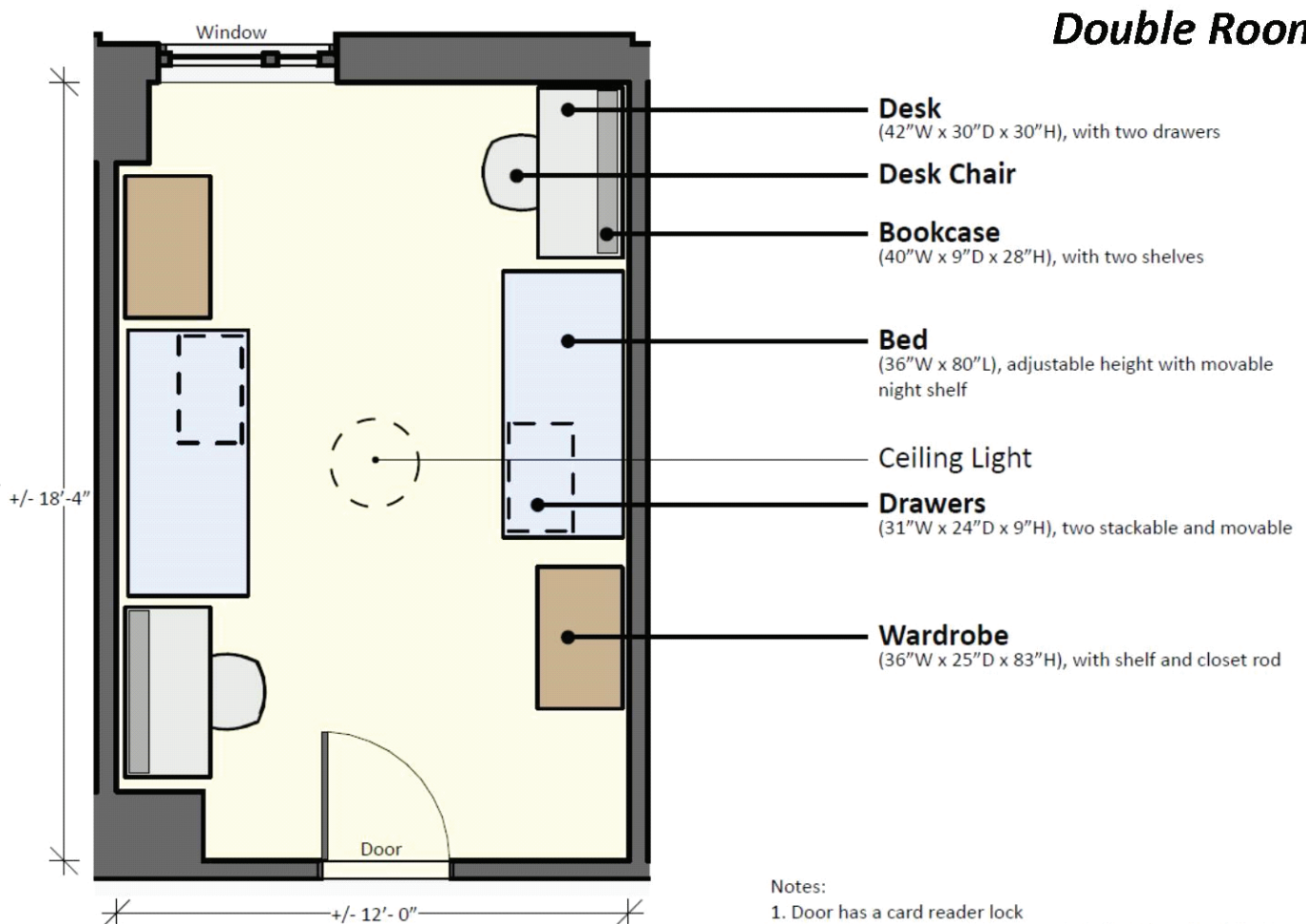

### Student Room - Double

New England Conservatory of Music - Student Life and Performance Center

#### Notes:

1. Door has a card reader lock
2. The window is openable and supplied with a roller blind
3. Each room has its own heating and air conditioning controls
4. Walls are painted; flooring is vinyl